

## 2 Mega Pixel Smart Analytics Varifocal Bullet Network Camera

### Key Features

- ❖ Day/night functionality
- ❖ Ultra 265, H.265, H.264, MPEG compression
- ❖ Smart IR, up to 50m
- ❖ Up to 120 dB Optical Wide Dynamic Range
- ❖ ONVIF Conformance
- ❖ IP67



SCL-OBL02VFIR-IX42BL

### Technical Specifications

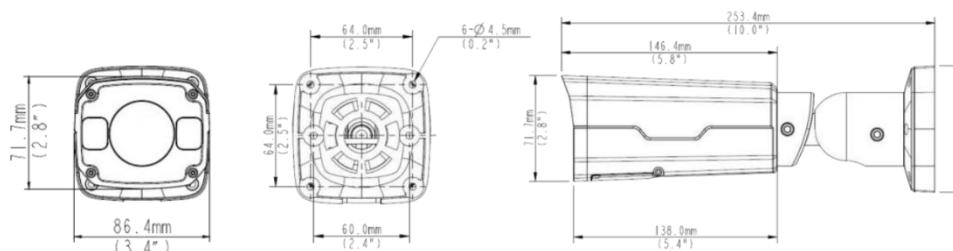

Model	SCL-OBL02VFIR-IX42BL				
Product Name	2 Mega Pixel Smart Analytics Varifocal Bullet Network Camera				
Camera					
Image Sensor	1/2.8" Progressive scan, 2.0 megapixel, CMOS				
Angle of View	94.0° ~ 28° (H), 56.7° ~ 14.4° (V), 122.2° ~ 34.4° (O)				
Min.illumination	Colour:0.002lux (F1.6, AGC ON) 0Lux with IR				
WDR	120dB WDR				
Signal/Noise Ratio	>52dB				
Shutter	Auto/Manual, 1 ~ 1/100000s				
Digital noise reduction	2D/3D DNR				
Lens	2.8 ~ 12mm@F1.6				
IR Range	Up to 50m				
DORI Distance	Lens (mm)	Detect (m)	Observe (m)	Recognize (m)	Identity (m)
	2.8	45	18	9	4.5
	12	192.9	77.1	38.6	19.3
Audio					
Audio Compression	G.711				
Two-way audio	Supported				
Sampling Rate	8KHZ				
Suppression	Supported				

This document is for planning purposes only and is not intended to modify or supplement any specifications or warranties relating to the product. Securicorp Technologies UK Ltd. reserves the right to change product images and specifications at any time without notice. All pictures shown are for illustration purpose only. Actual product may vary due to product enhancement.

**SECURICORP TECHNOLOGIES UK LTD.**

Email: sales@securicorp.com, www.securicorp.com

## 2 Mega Pixel Smart Analytics Varifocal Bullet Network Camera

Video	
Video Compression	Ultra 265, H.265, H.264, MJPEG
Frame Rate	First Stream: 2MP (1920*1080), Max 30fps;
	Second Stream: 2MP (1920*1080), Max 30fps;
	Third Stream: D1 (720*576), Max 30fps
OSD	Up to 8 OSDs
Privacy Mask	Up to 8 areas
ROI	Up to 8 areas
Motion Detection	Up to 4 areas
Edge Storage	Micro SD, up to 256GB
Network	
Protocols	IPv4, IGMP, ICMP, ARP, TCP, UDP, DHCP, PPPoE, RTP, RTSP, RTCP, DNS, DDNS, NTP, FTP, UPnP, HTTP, HTTPS, SMTP, 802.1x, SNMP, QoS
Compatible Integration	ONVIF (Profile S, Profile G, Profile T), API
Interface	
Alarm I/O	2/1
Audio I/O	Input : impedance 35kΩ
	Output : impedance 600Ω
Network	1 RJ45 10M/100M Base-TX Ethernet
General	
Power Consumption	<9W
Power Supply	DC 12V±25%, PoE (IEEE 802.3af)
Working Environment	-35°C ~ 60°C (-31°F ~ 140°F) <95% RH
Dimensions	253.4 x 84 x 71.7mm
Weight	1.0 kg
Ingress Protection	IP67